

# IOS Smart Home Application Software (AP-ISH100)

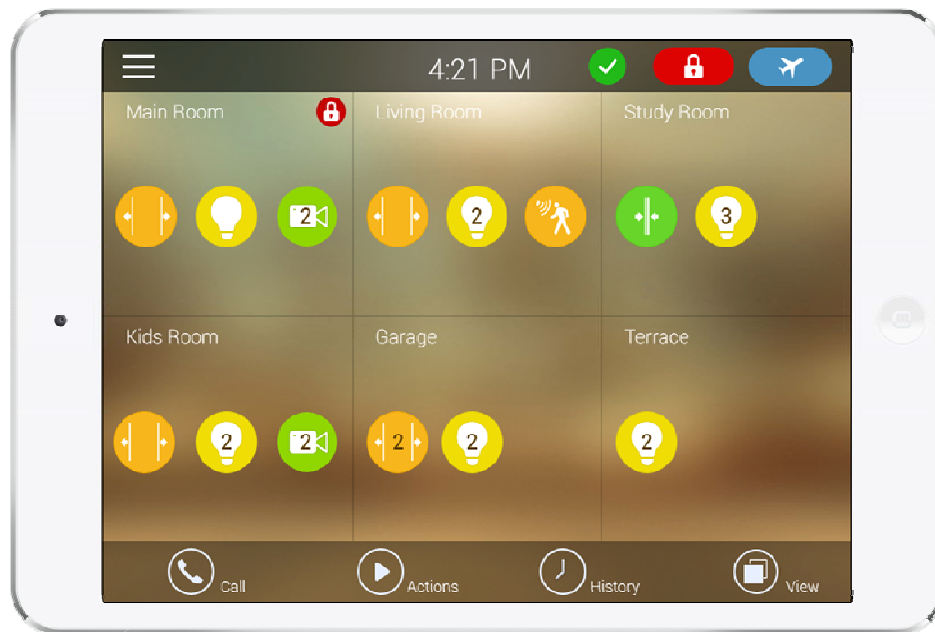

**AddPac**

**AddPac Technology**

Sales and Marketing

[www.addpac.com](http://www.addpac.com)

# Contents

- AP-ISH100 IOS Smart Home Appl. Overview
- AP-ISH100 Network Service Diagram
- AP-ISH100 SIP Register Diagram
- AP-ISH100 SIP Video Call Flow Diagram
- AP-ISH100 UI Design (examples)

# IOS Smart Home Software (Apple IOS App.)



# AP-ISH100 Overview

- It supports receiving a video call from video door phone by visitor.
- It supports making a video call to video door phone to see door side.
- It supports bidirectional video call from security guard video phone.
- It supports smart hub devices for sensor device handling.
- It supports IP camera view mode using RTSP protocol
- It supports standard based SIP signaling protocol.
- It supports below voice and video codecs
  - Voice Codec : G.711ulaw/alaw, G.726
  - Video Codec : H.264, H.263, MPEG4

# AP-ISH100 Network Service Diagram

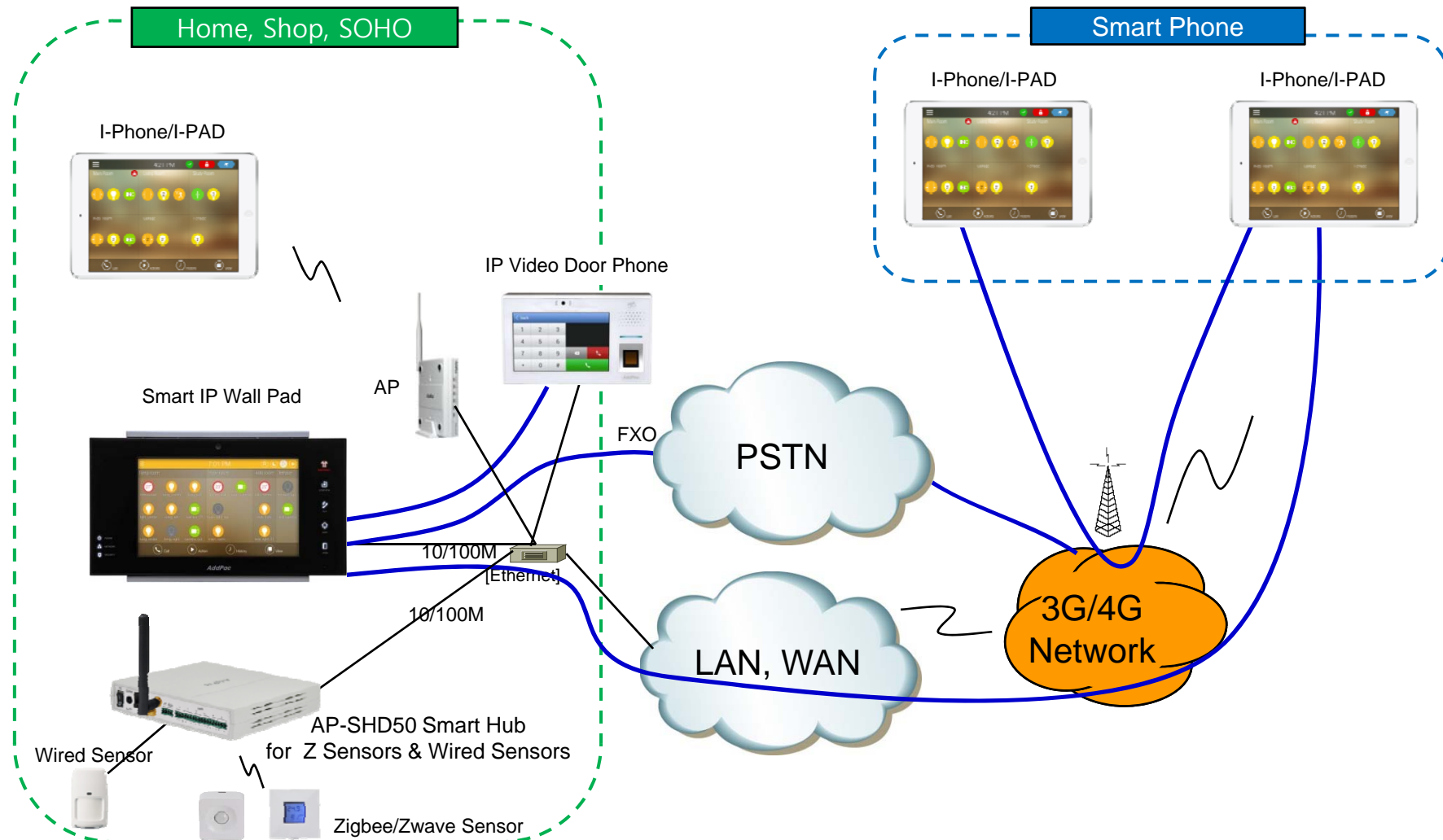

# SIP Register

Smart Home Application Register to AP-VWP000

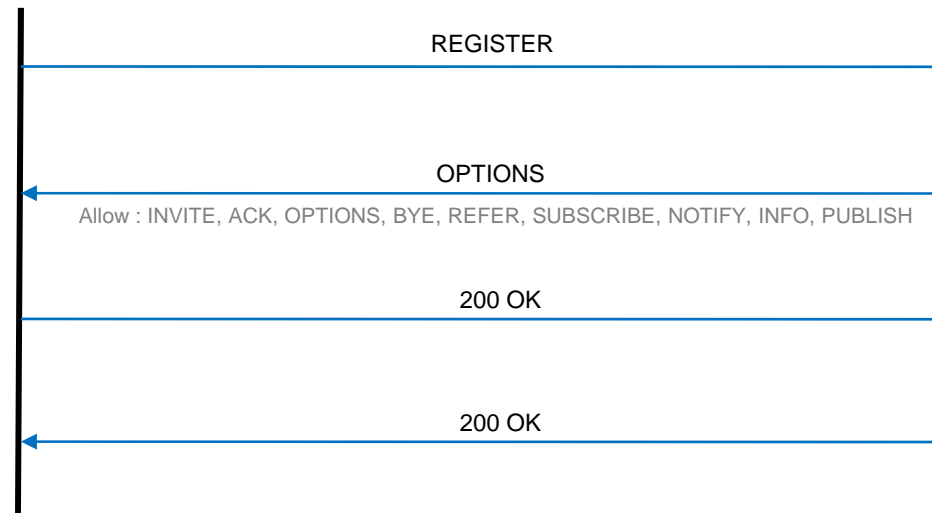
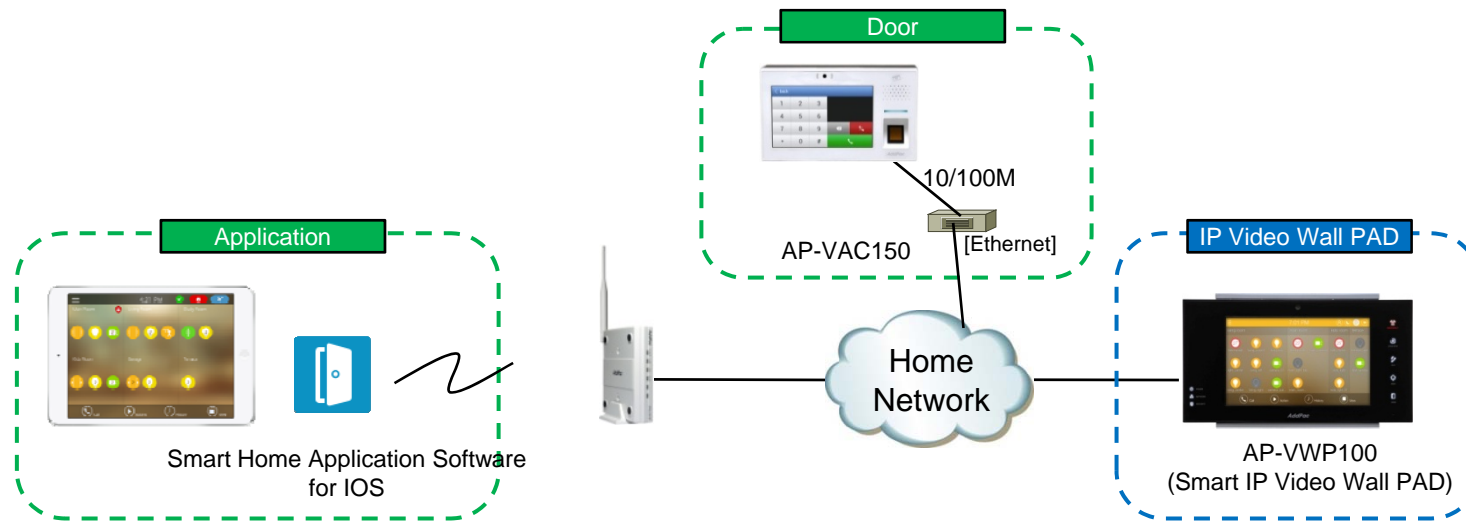

# SIP Video Call Flow

## Door Open Flow

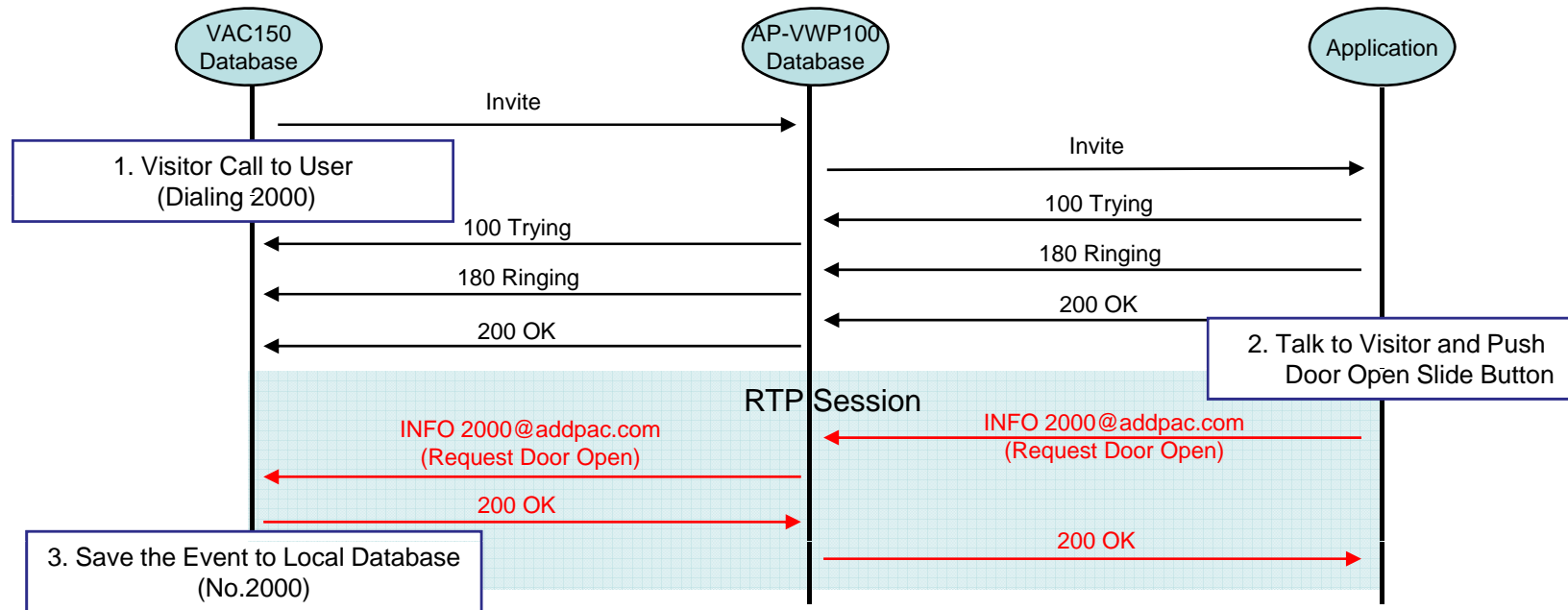

# UI examples Lists

- Main View (Zone Summary)
- Armed Mode (Away, Stay, Night)
- Short View
- Zone View
- Zone Setting and Configuration
- IP Camera View Mode (Home, Outside Home)
- Call View (Favorite Call, Recent Call, Phone Book, etc)
- Video Call View
- Sensor Control View (Ex: Light Control, Thermostat, etc)
- Sensor Control View (Action, Mode, Alert, etc)



# Main View (Zone Summary)

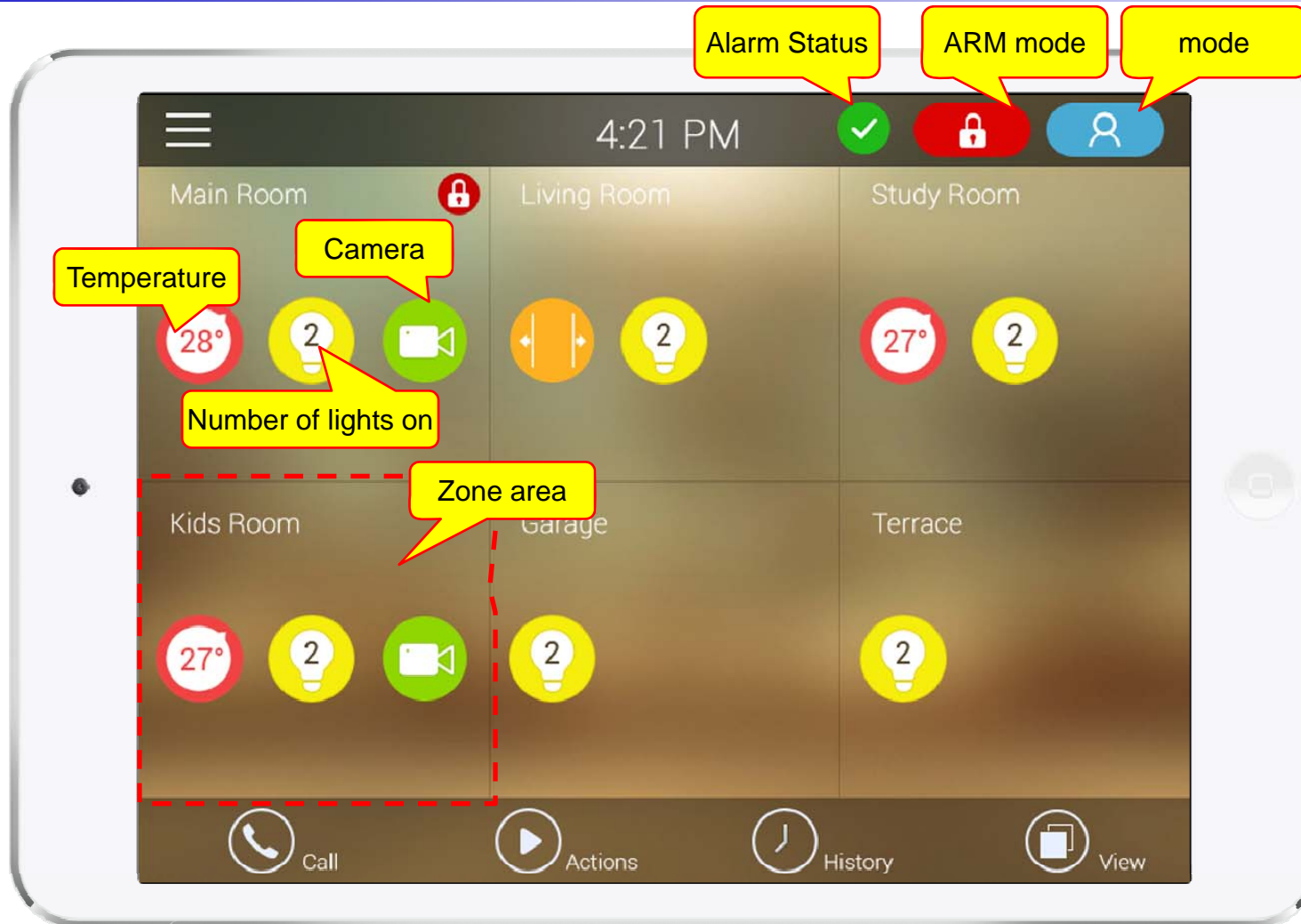

# Main View (Cont.)



# Main View (Zone Detail)

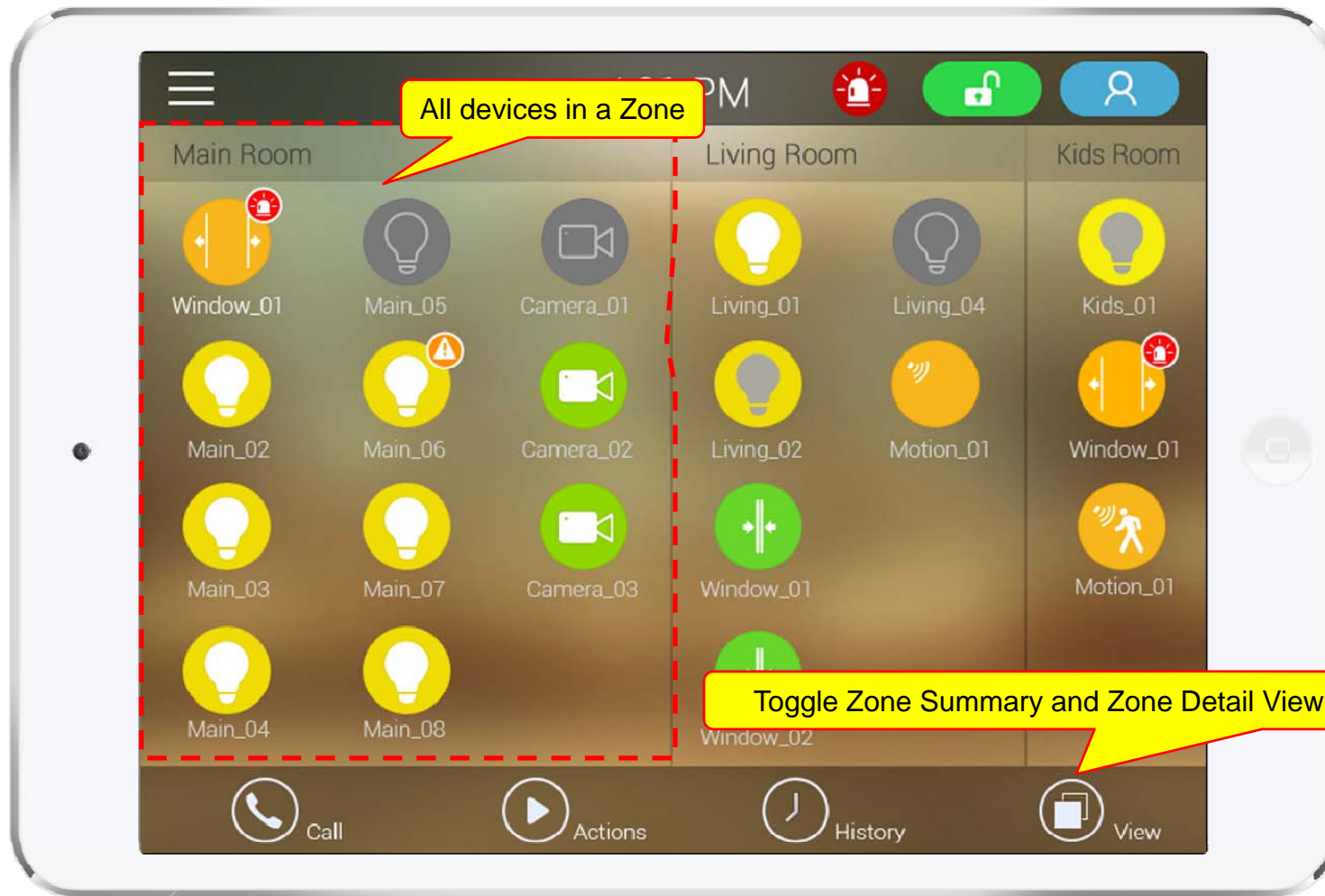

# Armed Mode



# Short Cut View

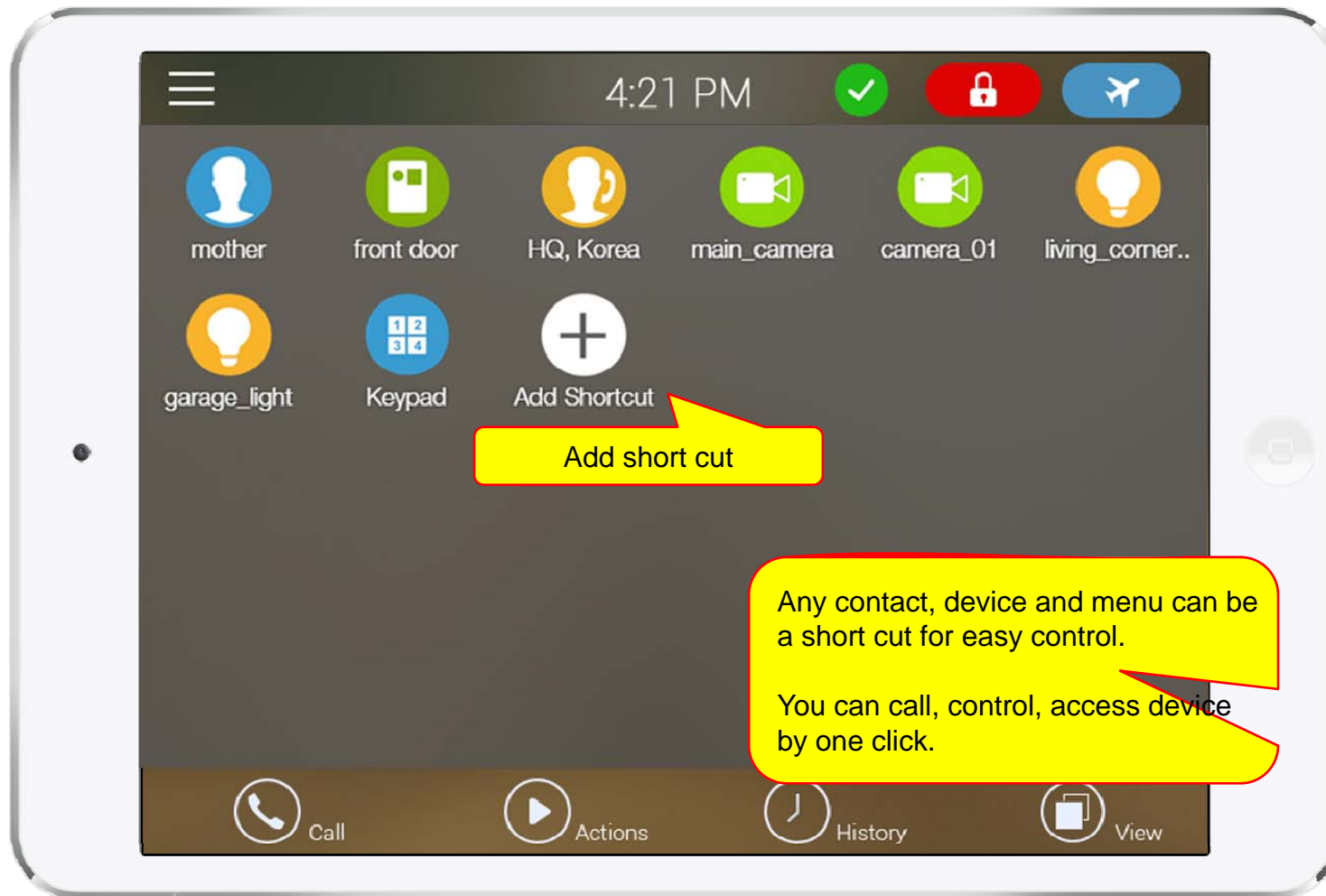

# Zone View

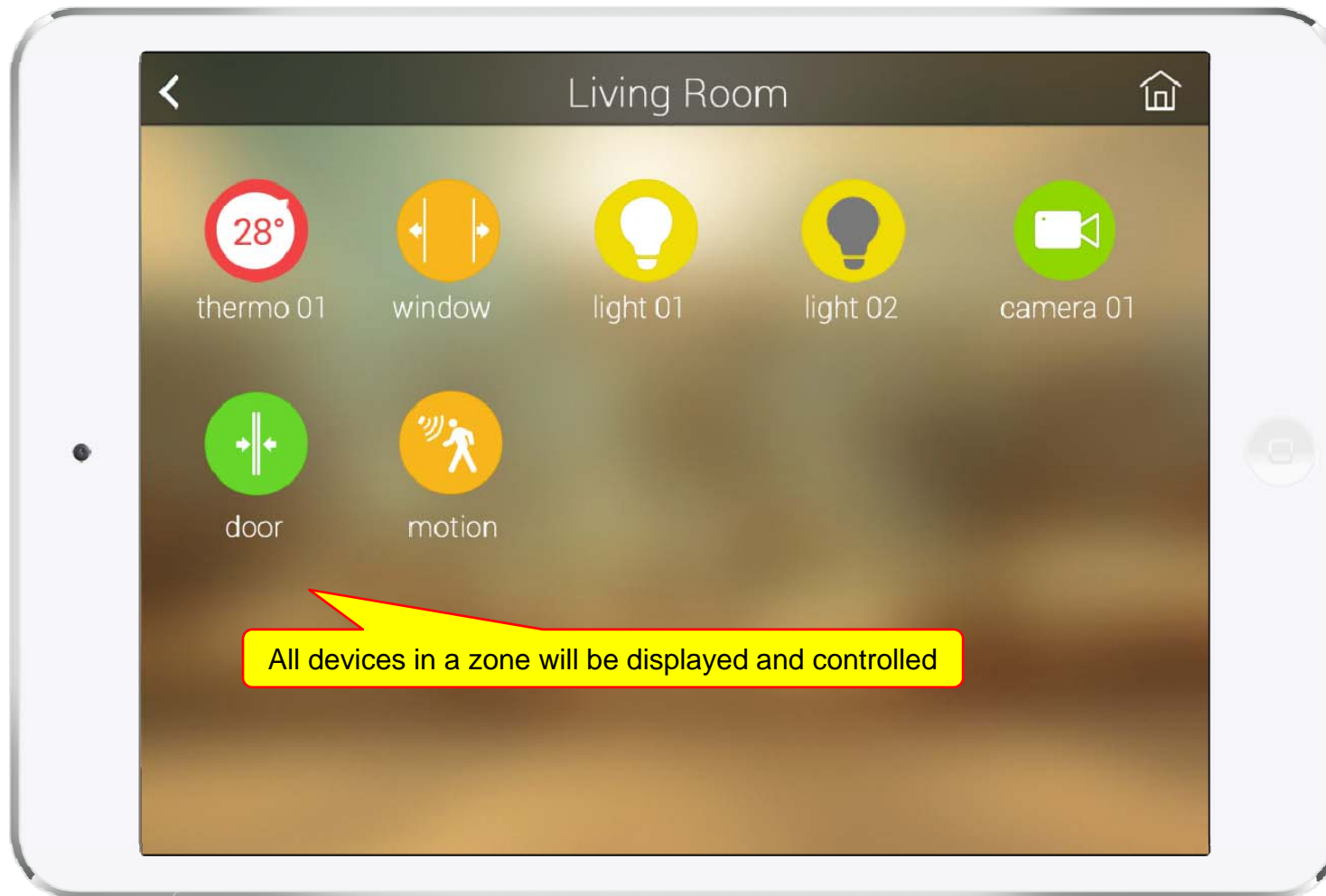

# Zone Setting

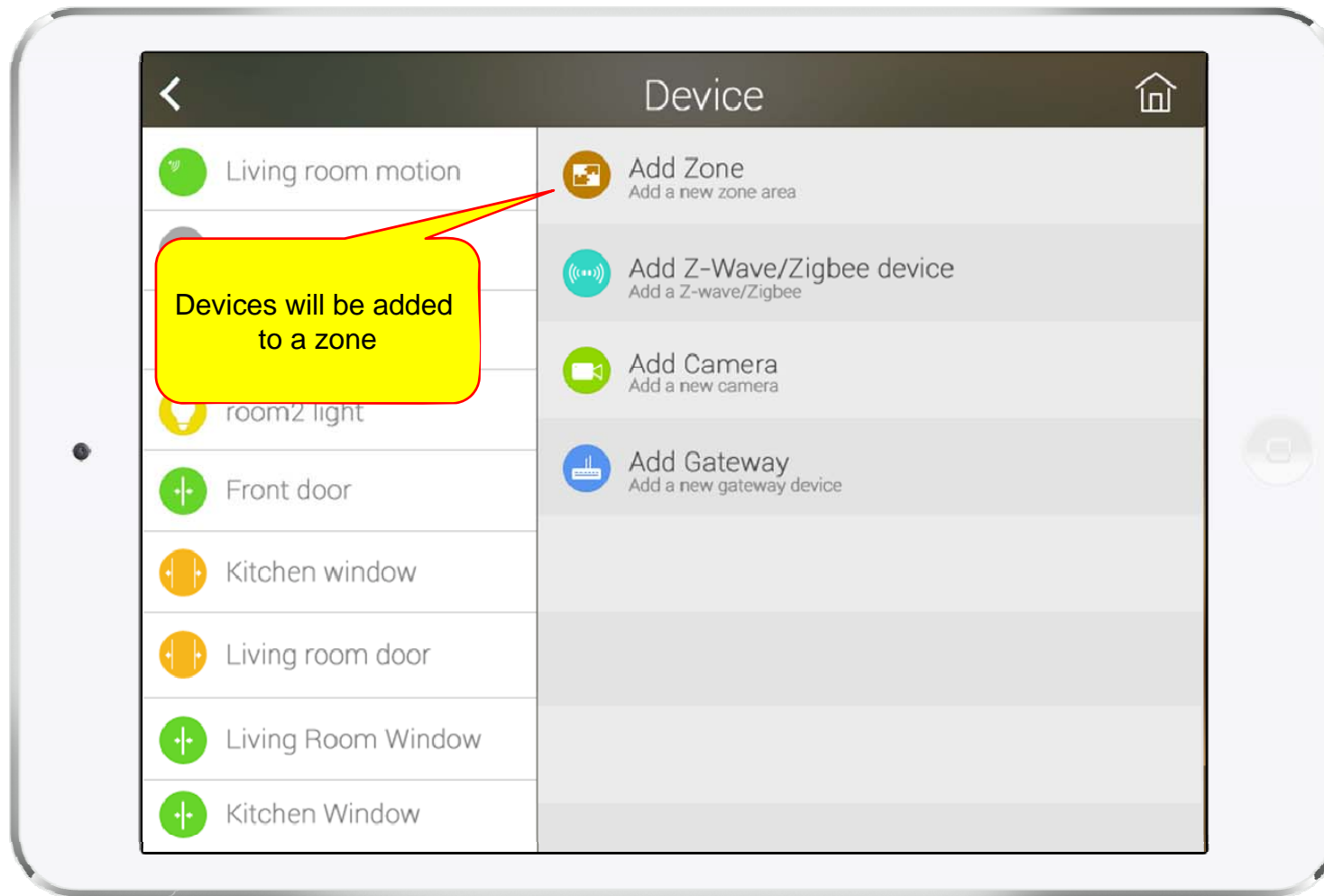

# Camera Live View

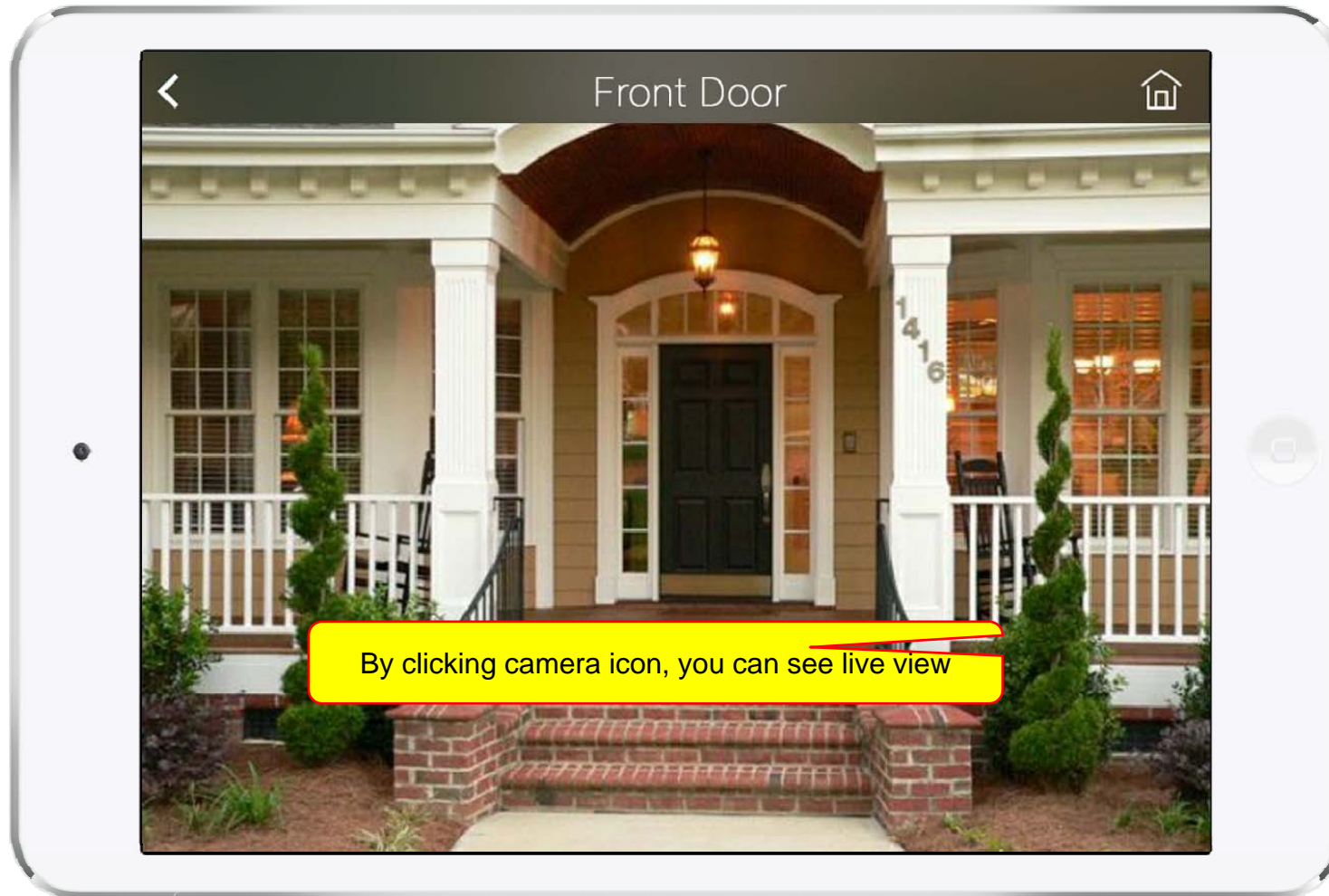



# Light Control

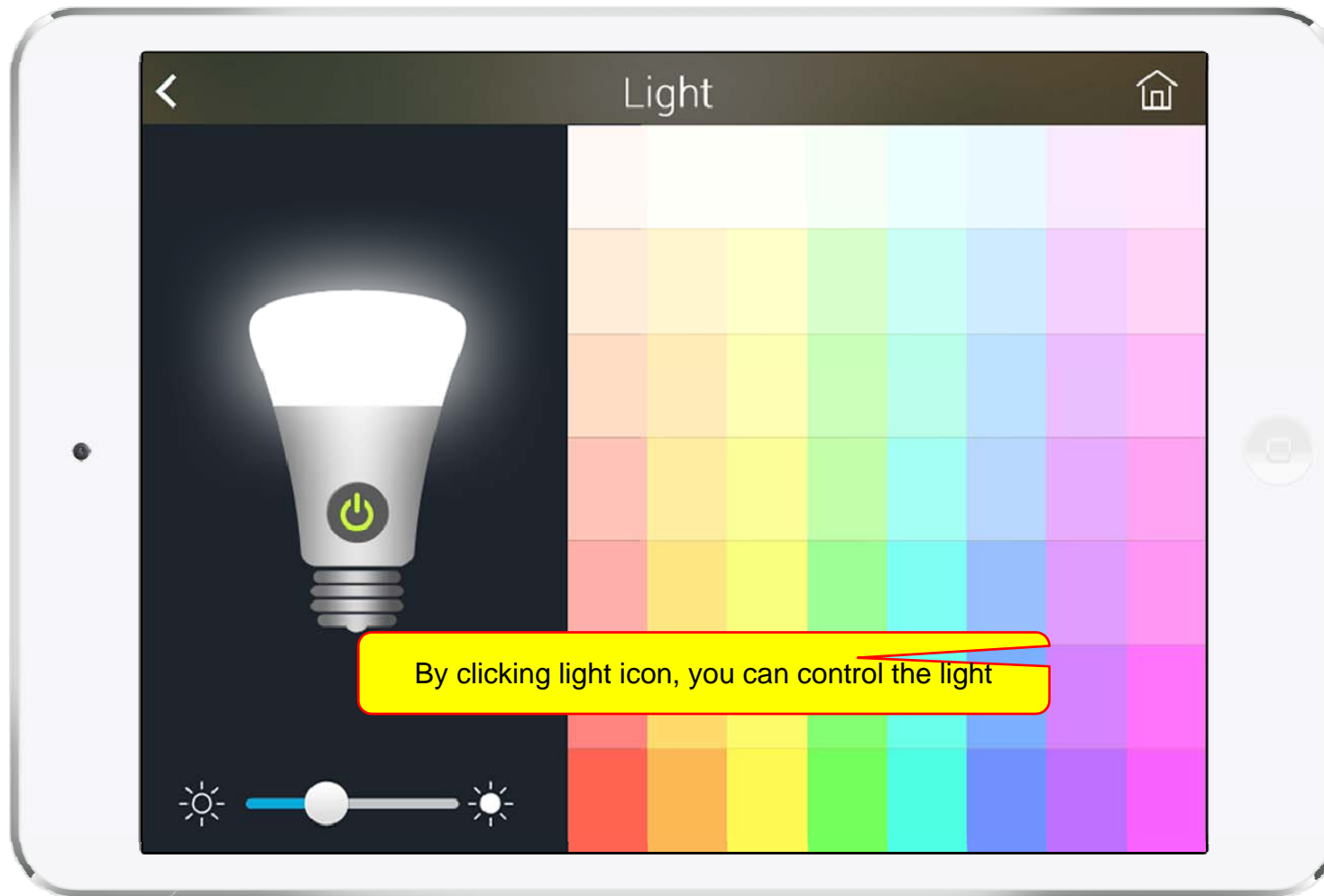

# Thermostat

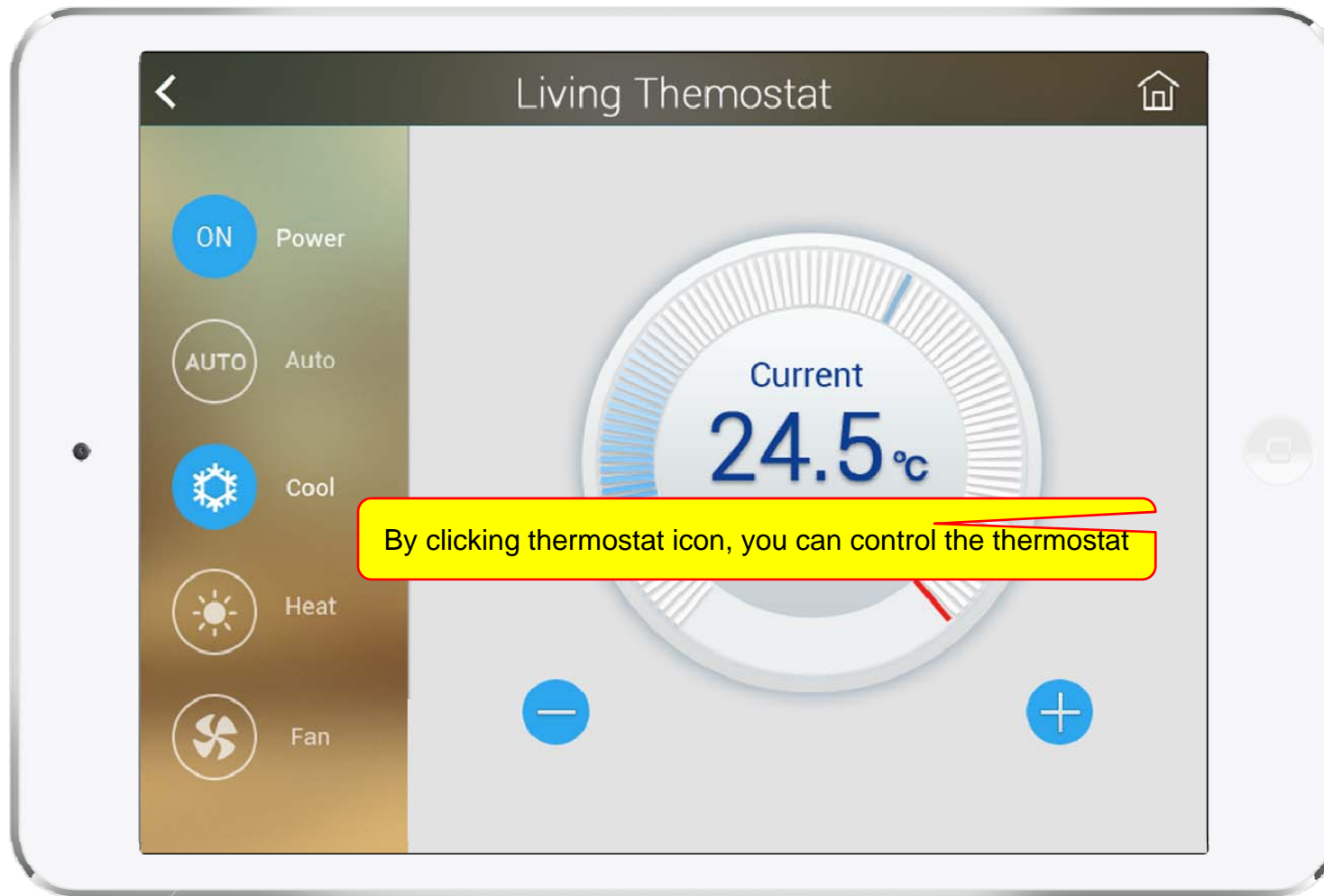

# Favorite Call View

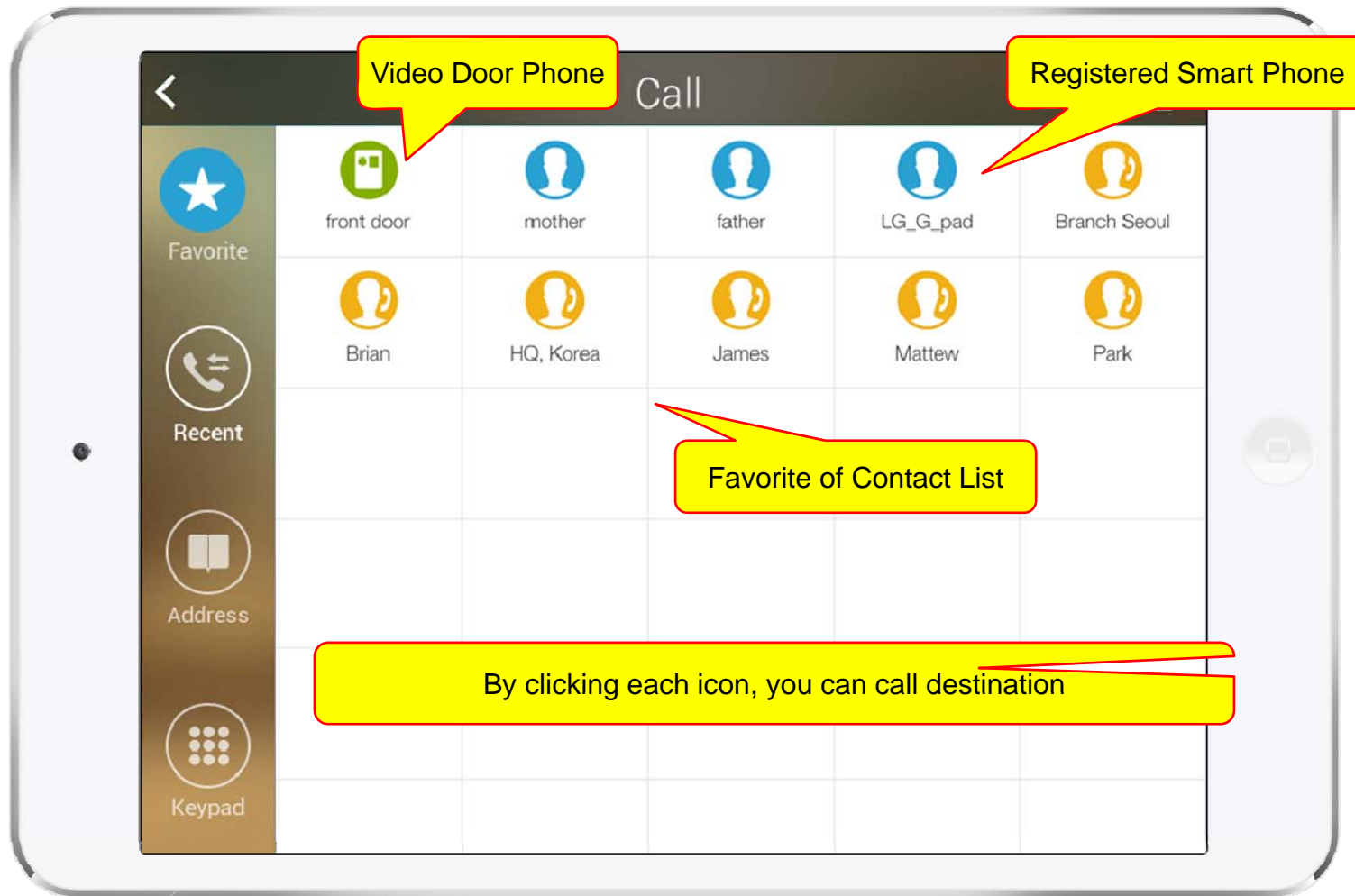

# Recent Call View

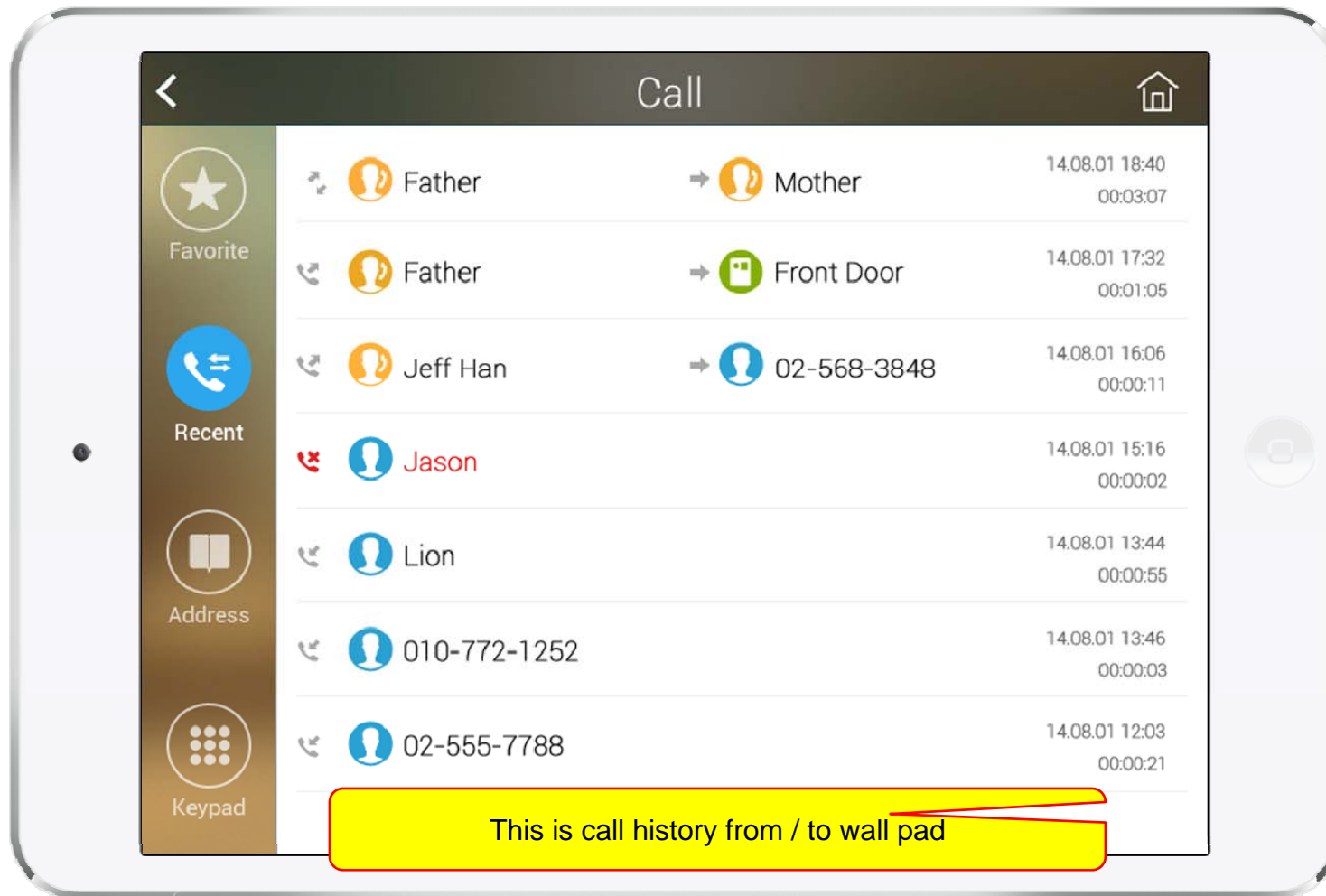

# Contact View

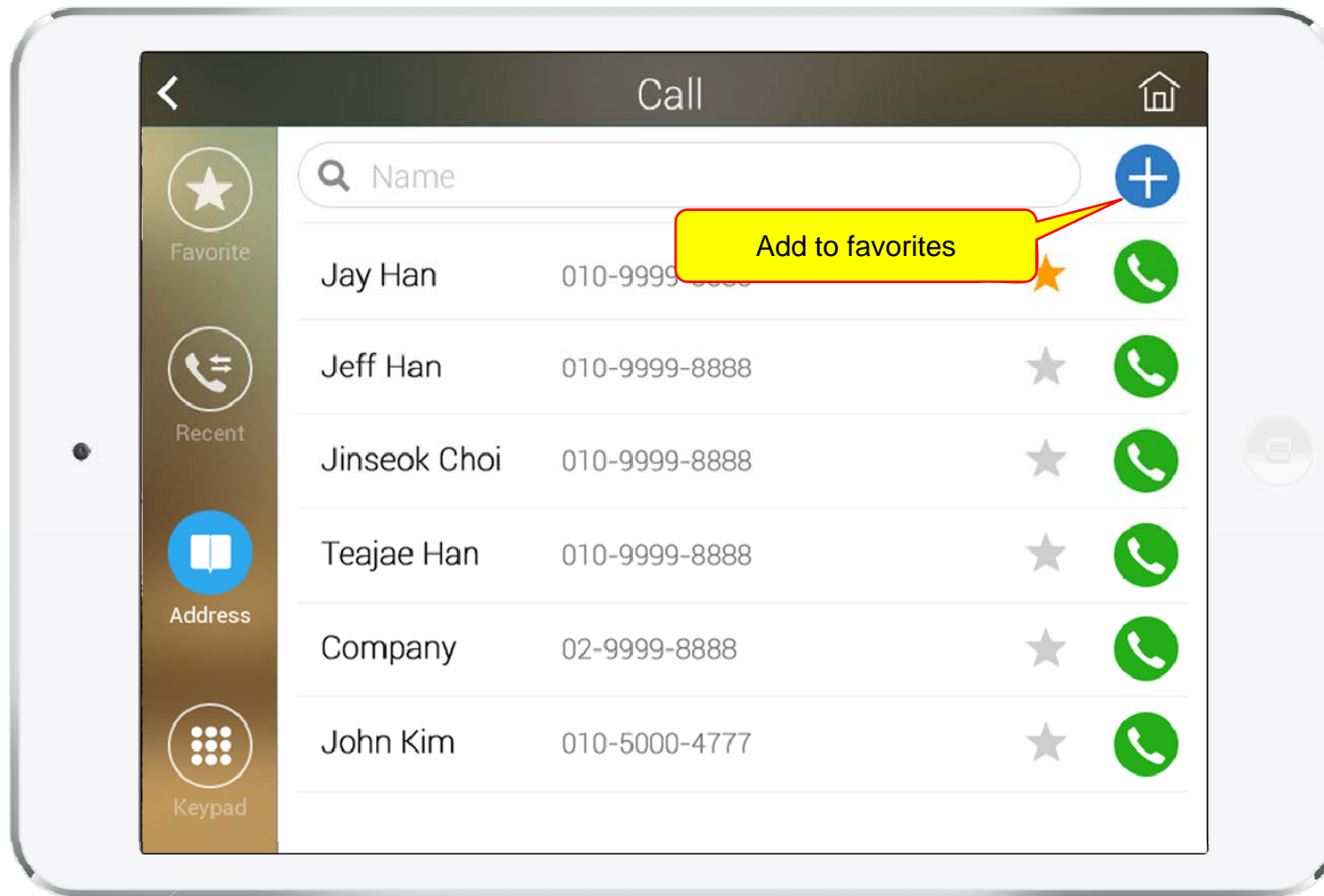

# Add Contact

The screenshot shows an iPad interface for adding a contact. At the top, there is a dark header bar with a back arrow on the left, the text 'HQ, Korea' in the center, and a home icon on the right. Below the header, the section is titled 'Contact Info'. It contains two input fields: 'Name\*' with the value 'HQ, Korea' and 'Phone Number\*' with the value '81-2-567-3849'. Each field has a small 'x' icon to its right. Below these fields is a light gray area with the text 'Please enter the information above.' Underneath that is a 'Favorite' section with a 'Favorite Contact' label and a green toggle switch that is currently turned on. At the bottom of the screen, there are two buttons: a red button with a white 'x' icon and the text 'Delete', and a green button with a white pencil icon and the text 'Done'.

# Keypad View

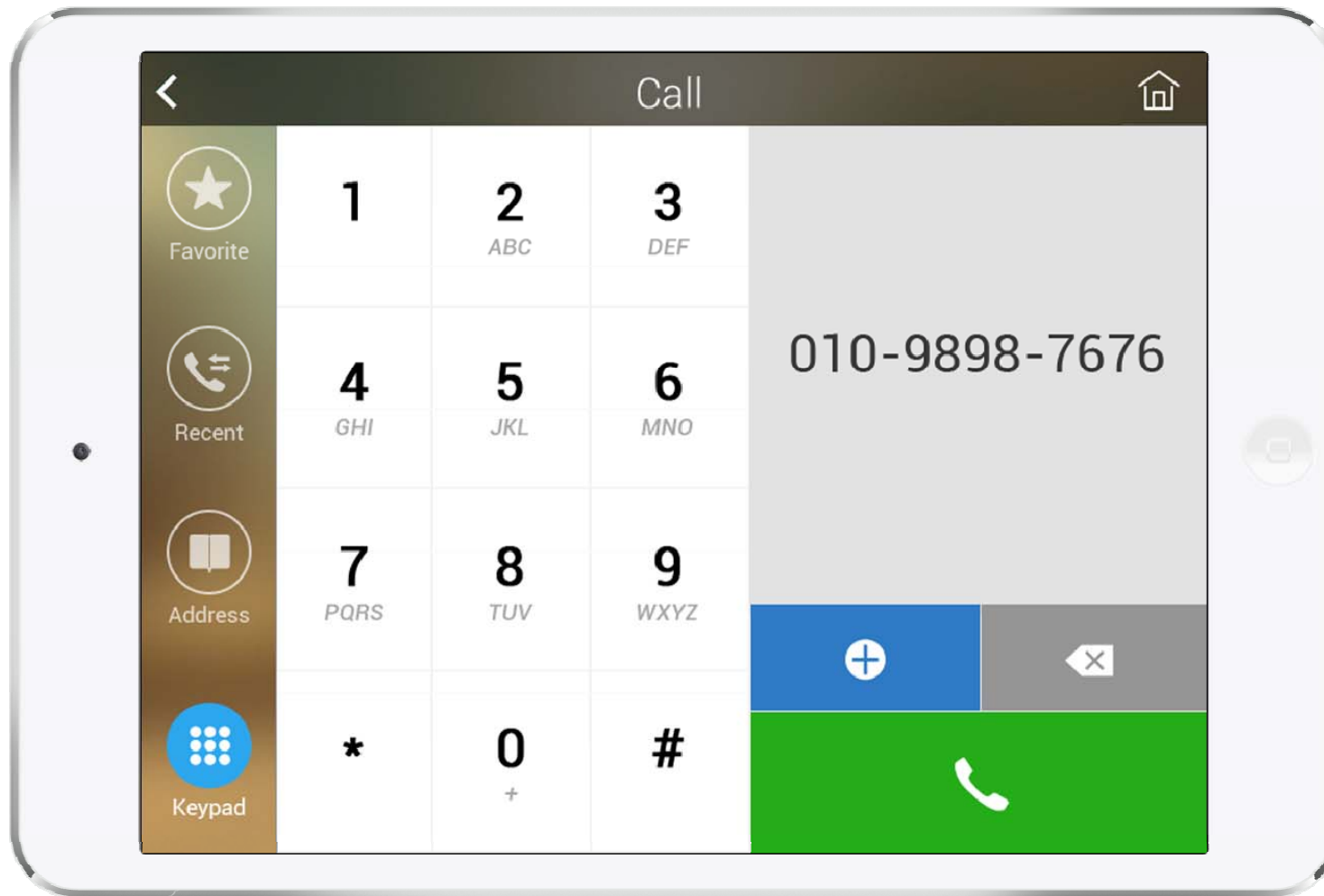

# Video Call View

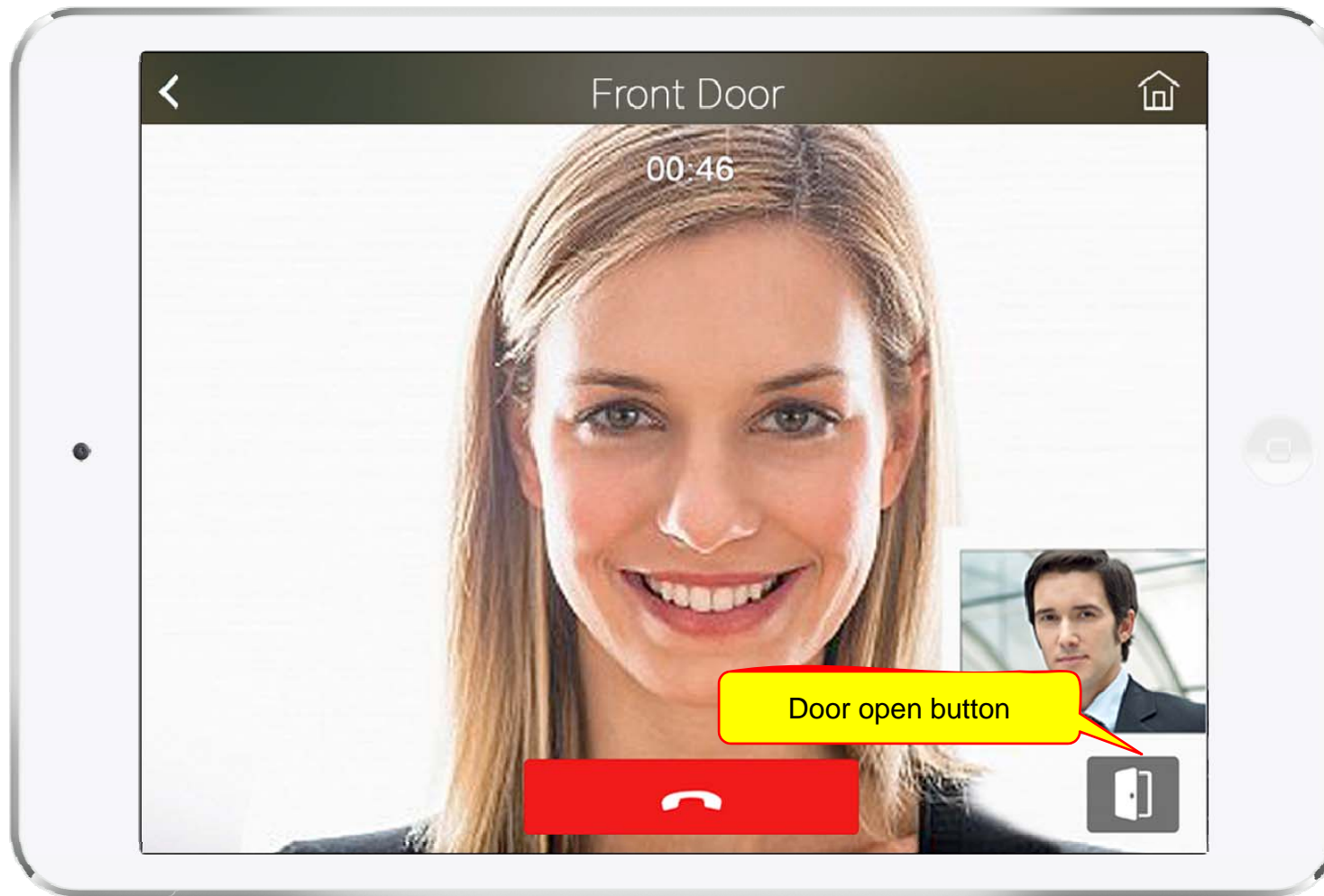



# Light Control

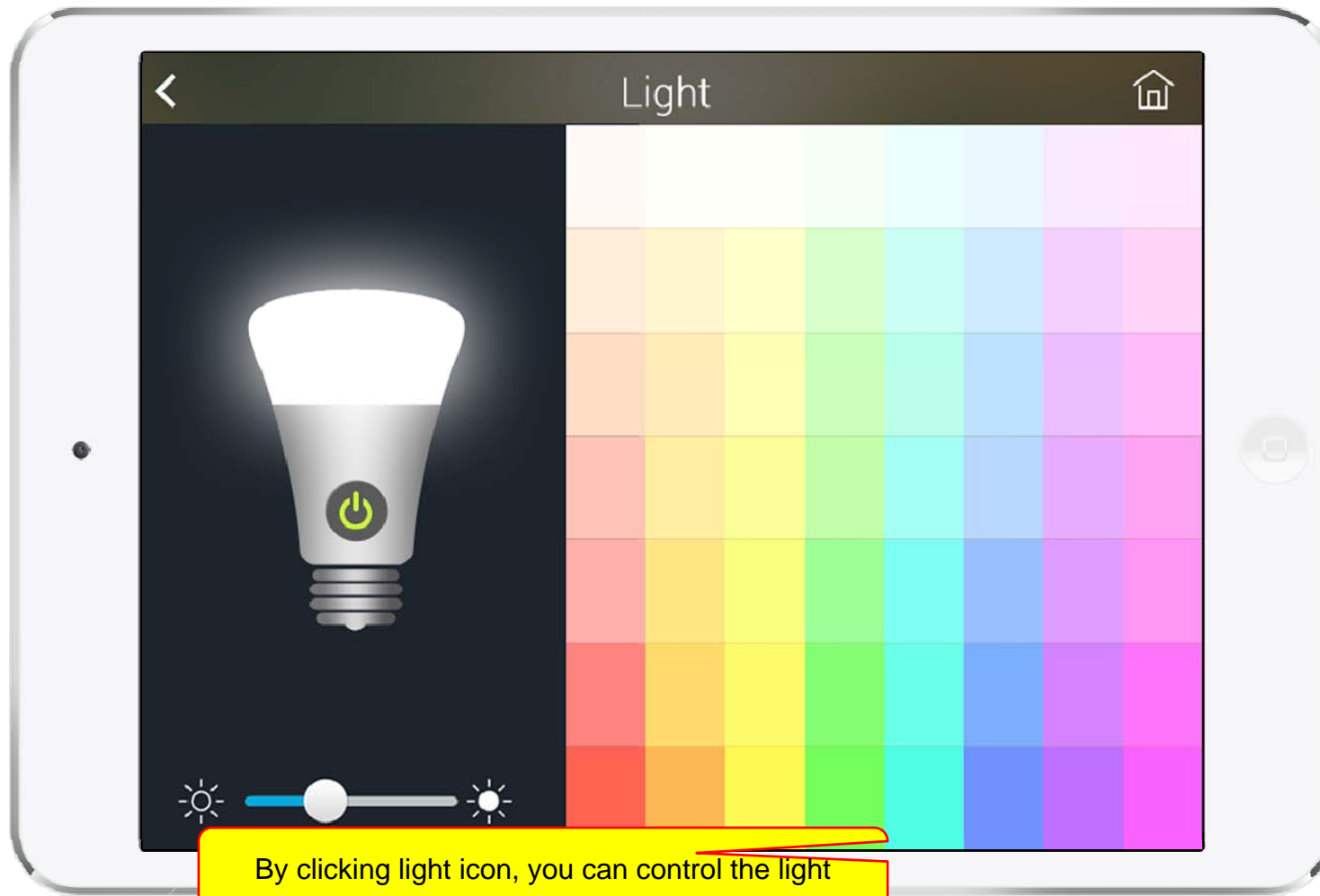

# Thermostat

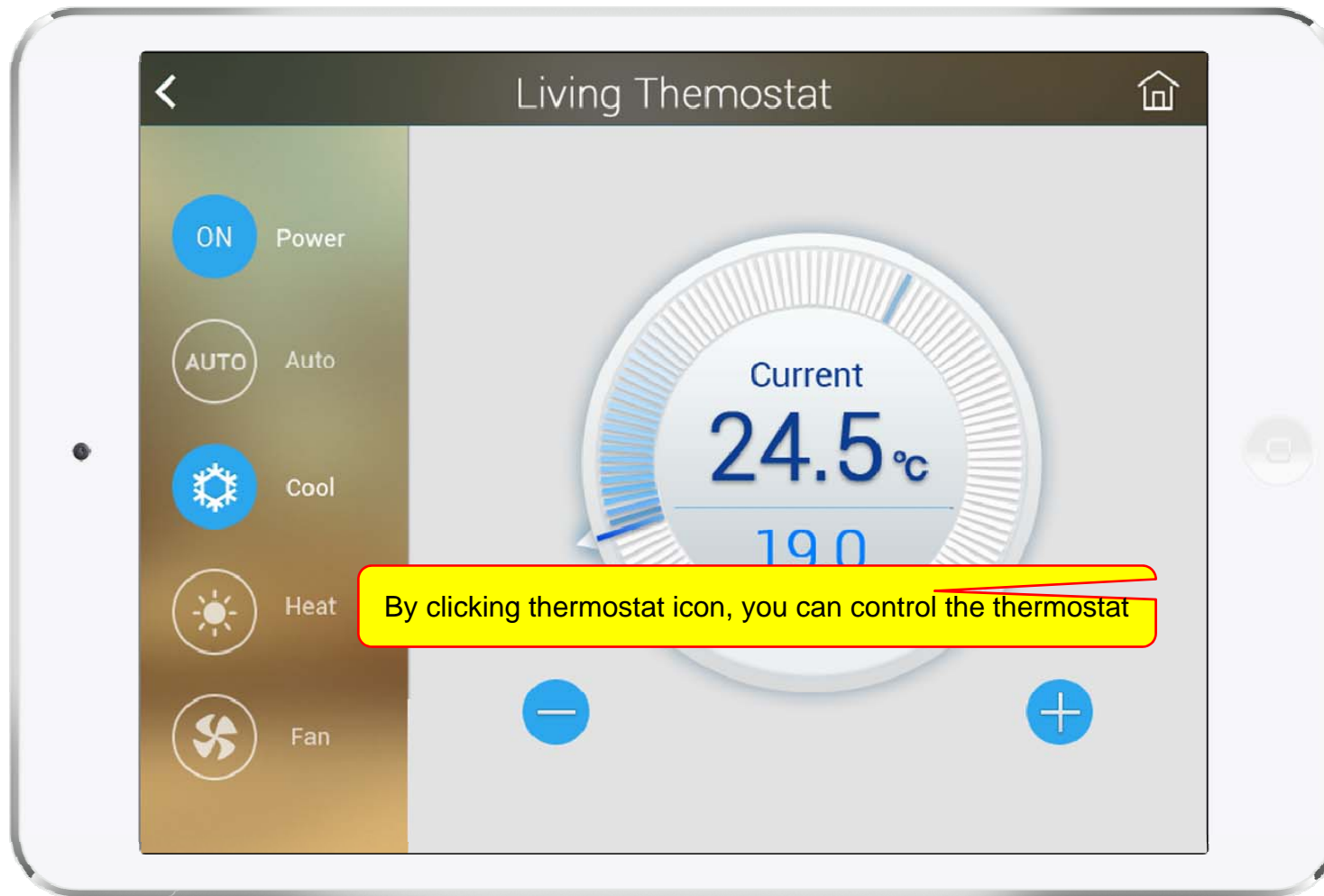

# Action View

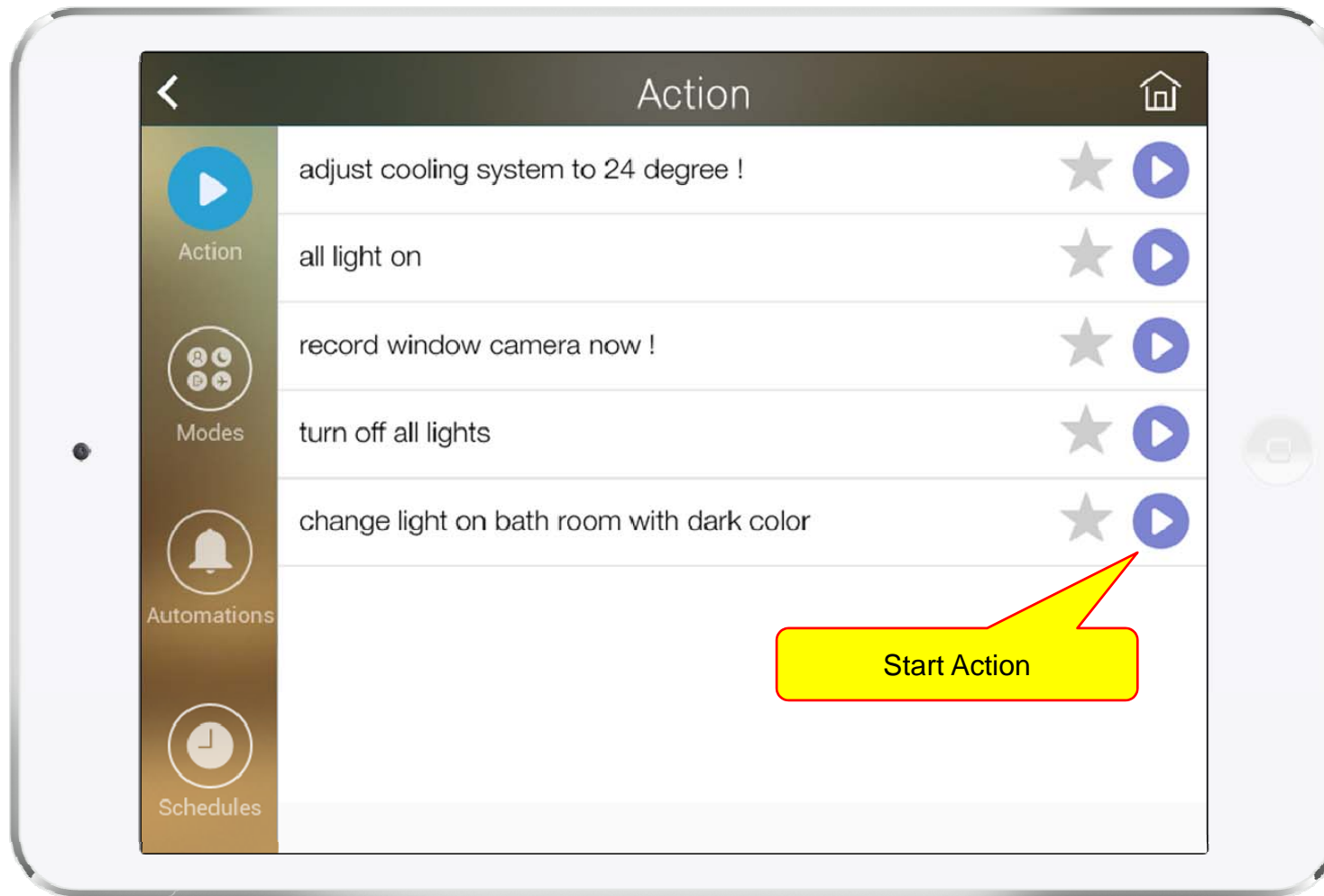

# Mode View

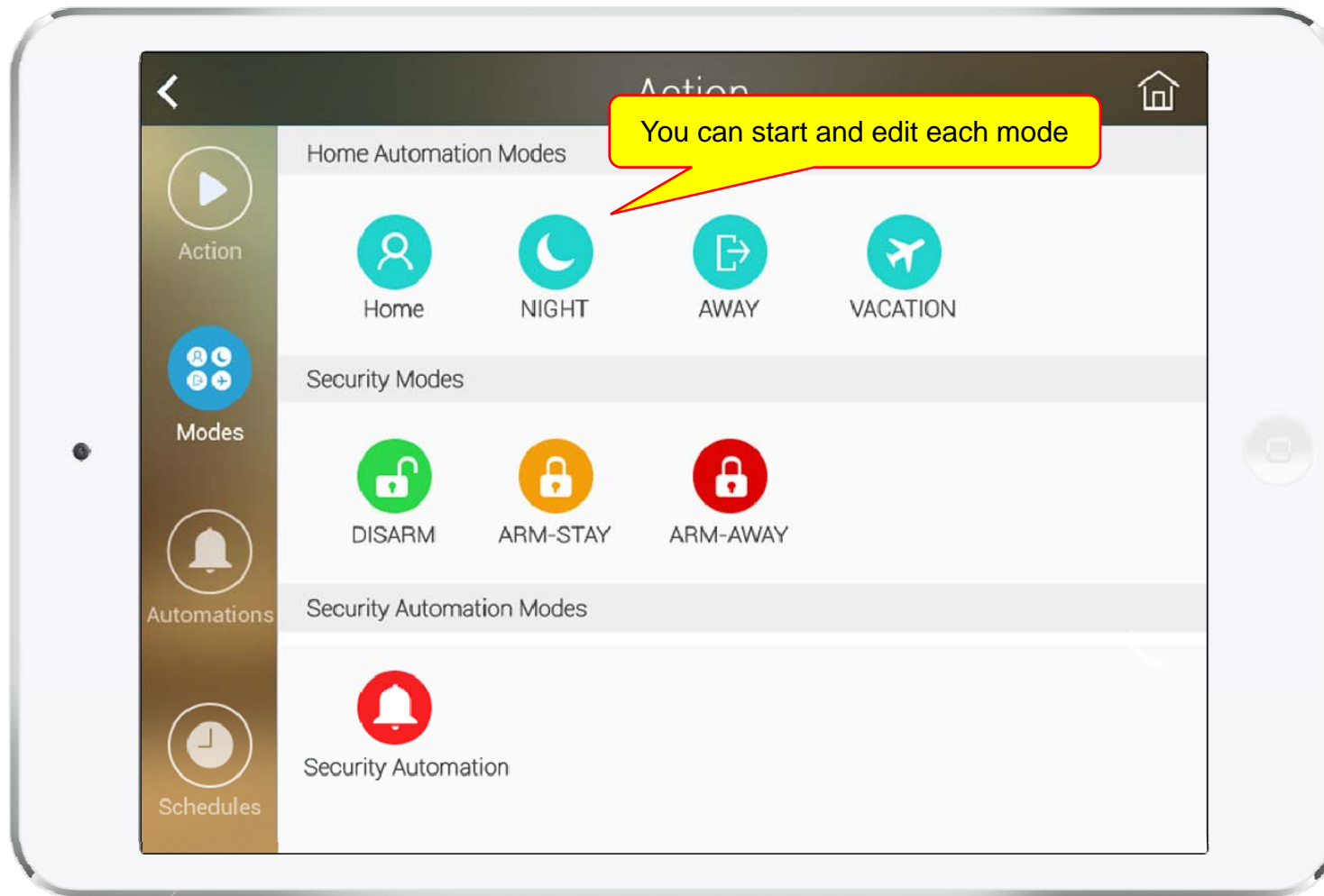

# Alert View

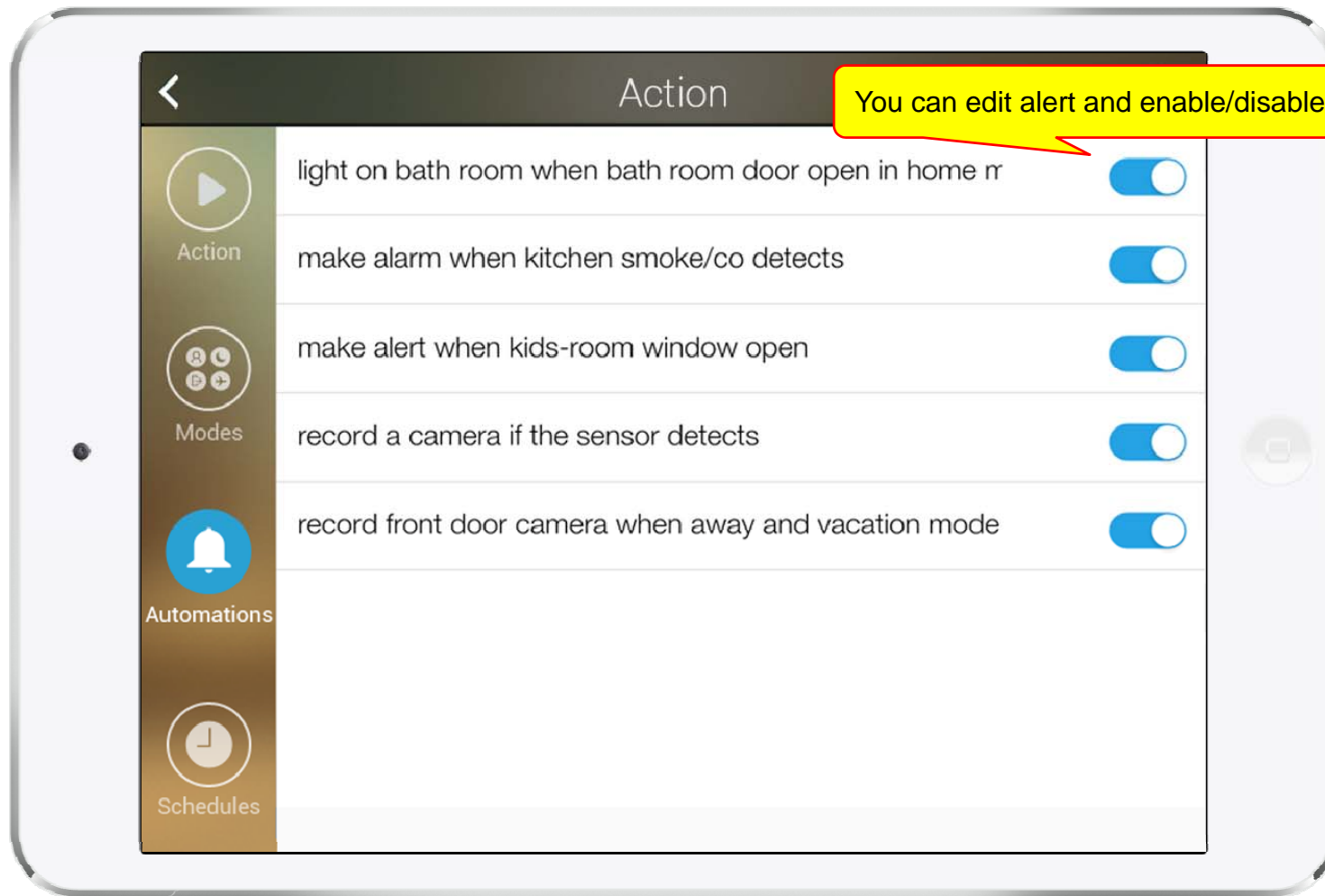

# Schedule View

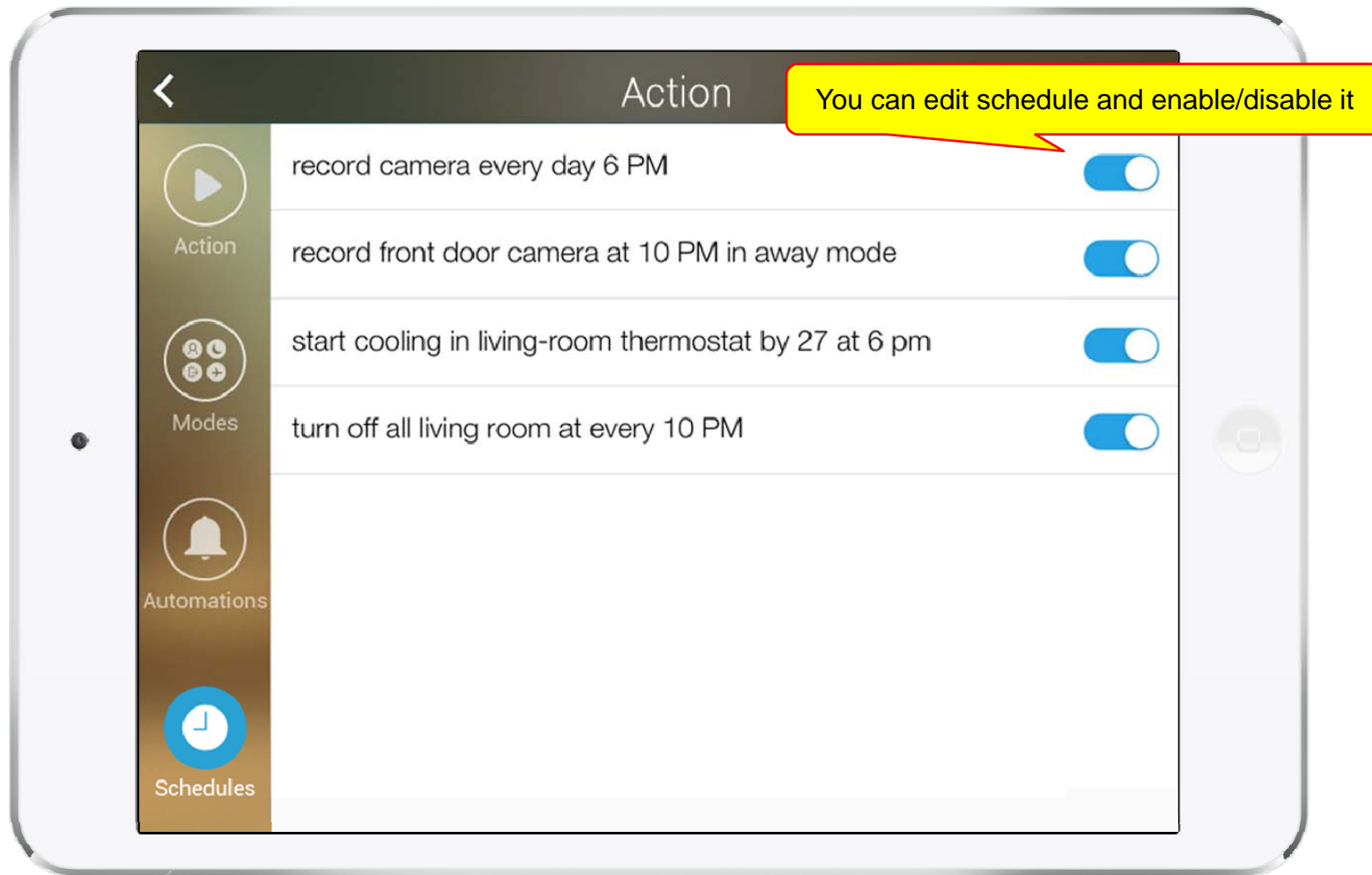

# Setting Menu

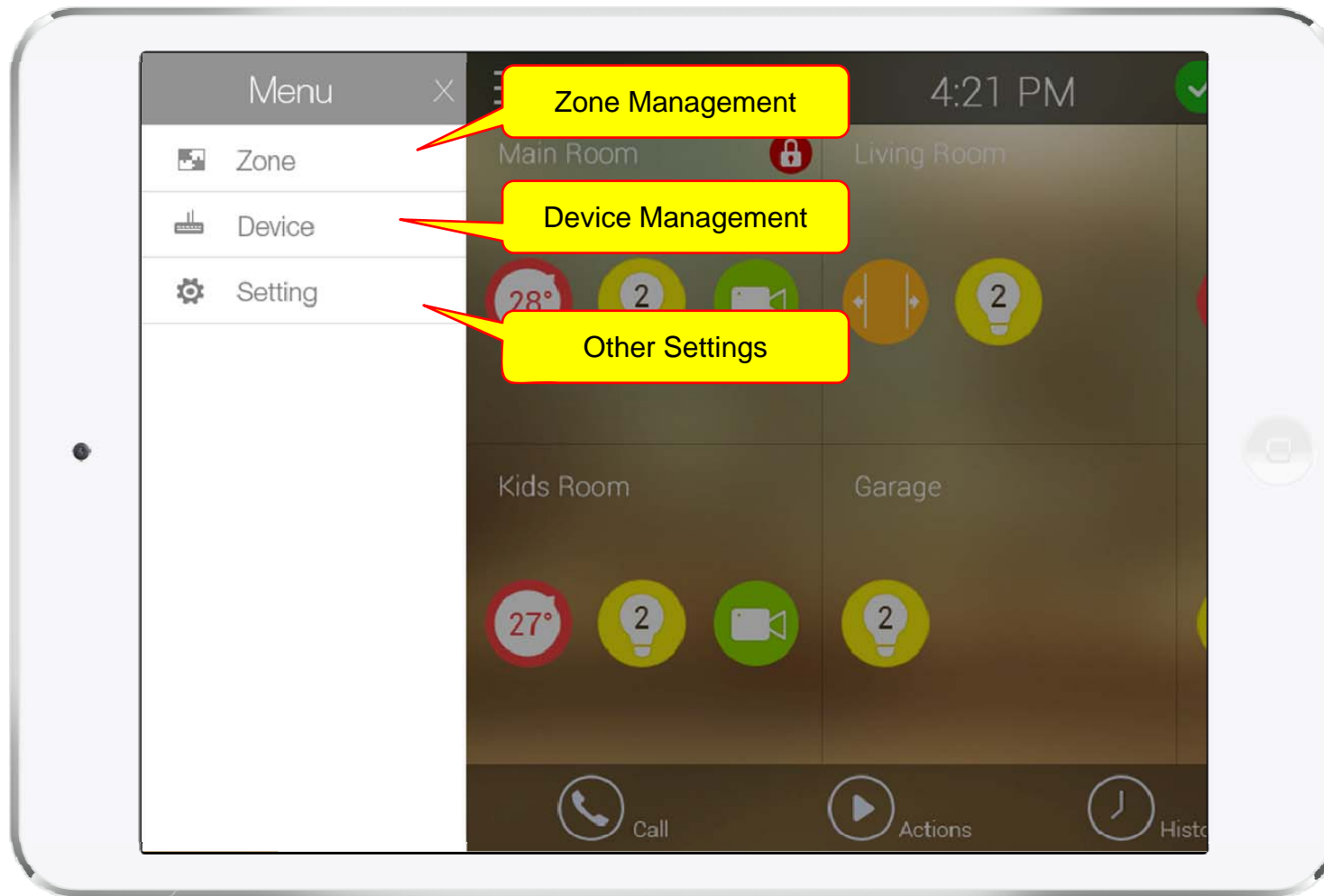



# Thank you!

**AddPac Technology Co., Ltd.**  
Sales and Marketing

Phone +82.2.568.3848 (KOREA)

FAX +82.2.568.3847 (KOREA)

E-mail : [sales@addpac.com](mailto:sales@addpac.com)